



# FLDL-SG1

STORM PRO™ Fire-Rated Fusible Link Louver

## PRODUCT CUT SHEET

PROJECT:
SUBMITTED BY:
DATE:
NOTES:

### For 1 3/4" Thick Doors Up To 90 Minutes

- ▶ Blades Close When Activated By Fire/Heat
- ▶ 18 Ga. Cold Rolled Steel Frame
- ▶ 18 Ga. Cold Rolled Steel Adjustable "Z" Blades
- ▶ 12 Ga. Cold Rolled Steel Security Grille One Side
- ▶ Mitered Corners Secured With Reinforcing Clips
- ▶ Stainless Steel Spring
- ▶ 165° Fusible Link
- ▶ #8 x 1" Torx Security Pin Screws
- ▶ Free Area 40%
- ▶ Gray Primer (GPZ) Powder Coat Finish
- ▶ Available in Whole Inch Increments  
Minimum size: 10" x 6"  
Maximum size: 24" x 30"

#### Available Options

- ▶ Powder Coat Color Options - See Color Chart on [ngp.com](http://ngp.com)
- ▶ Aluminum Insect Screen - 22 Ga. 1/8" Square Mesh Installed on Exterior Side
- ▶ Galvanneal - A40 Steel Frame and Blades (Security Grille not Available in Galvanneal)
- ▶ Type 316 Stainless Steel - Specify FLDL-SG1-316SS,  
Stock Sizes: 12" x 12" 18" x 12" 18" x 18"  
24" x 12" 24" x 18" 24" x 24"

#### Windstorm Rated

- ▶ Louver for Use in Windstorm-Rated Assembly in Accordance with ANSI/ASTM E330, ANSI/ASTM E1886, ASTM E1996, AAMA/WDMA/CSA 101/I.S.2/A440, FEMA 320, FEMA 361 and ICC 500. Design Pressure = +/- 70 PSF, Large Missile Impact = 350 ft. lbs., Hazard - Hurricane
- ▶ Maximum Size for Hurricane Use is 24" x 24" (610mm x 610mm)

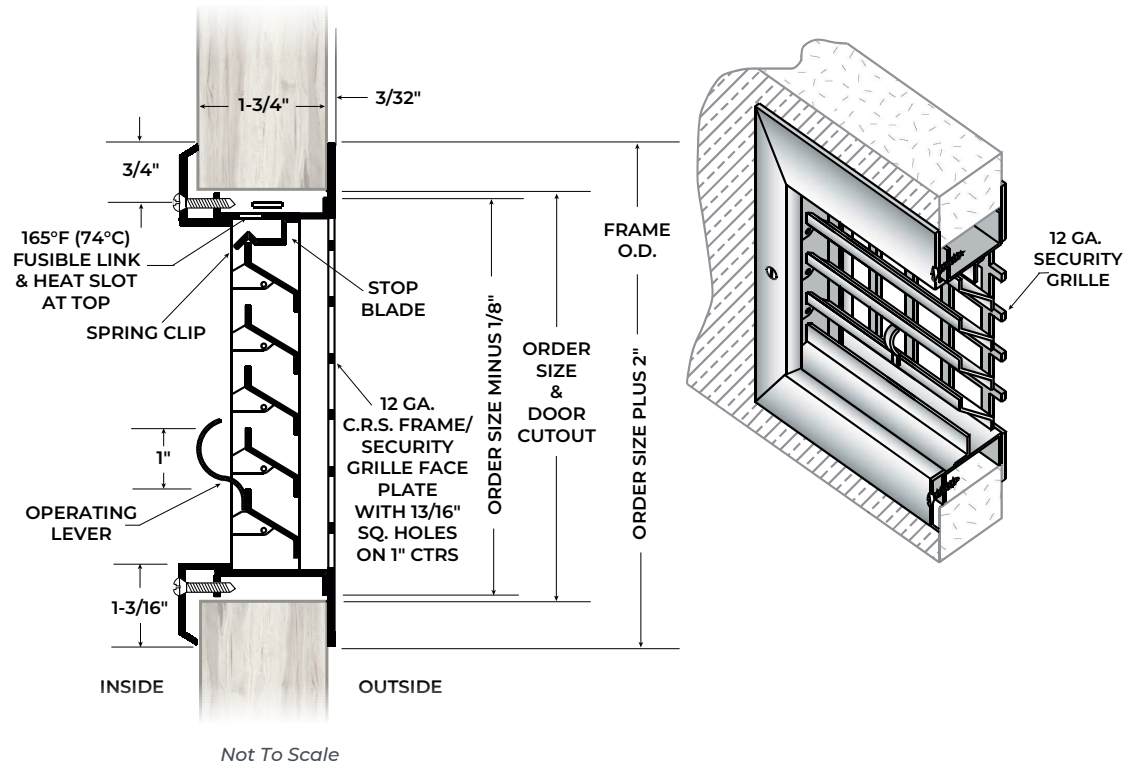

NGP-LIT-FLDL-SG1-PCS-0124-A

### NATIONAL GUARD PRODUCTS, INC.

#### MEMPHIS

4985 East Raines Road  
Memphis, TN 38118

#### CARSON CITY

3689 Arrowhead Drive  
Carson City, NV 89706

Fax: (800) 255-7874

Email: [info@ngp.com](mailto:info@ngp.com)

Quotes: [quotes@ngp.com](mailto:quotes@ngp.com)

Orders: [orders@ngp.com](mailto:orders@ngp.com)

**ngp.com**  
1-800-NGP-RUSH